

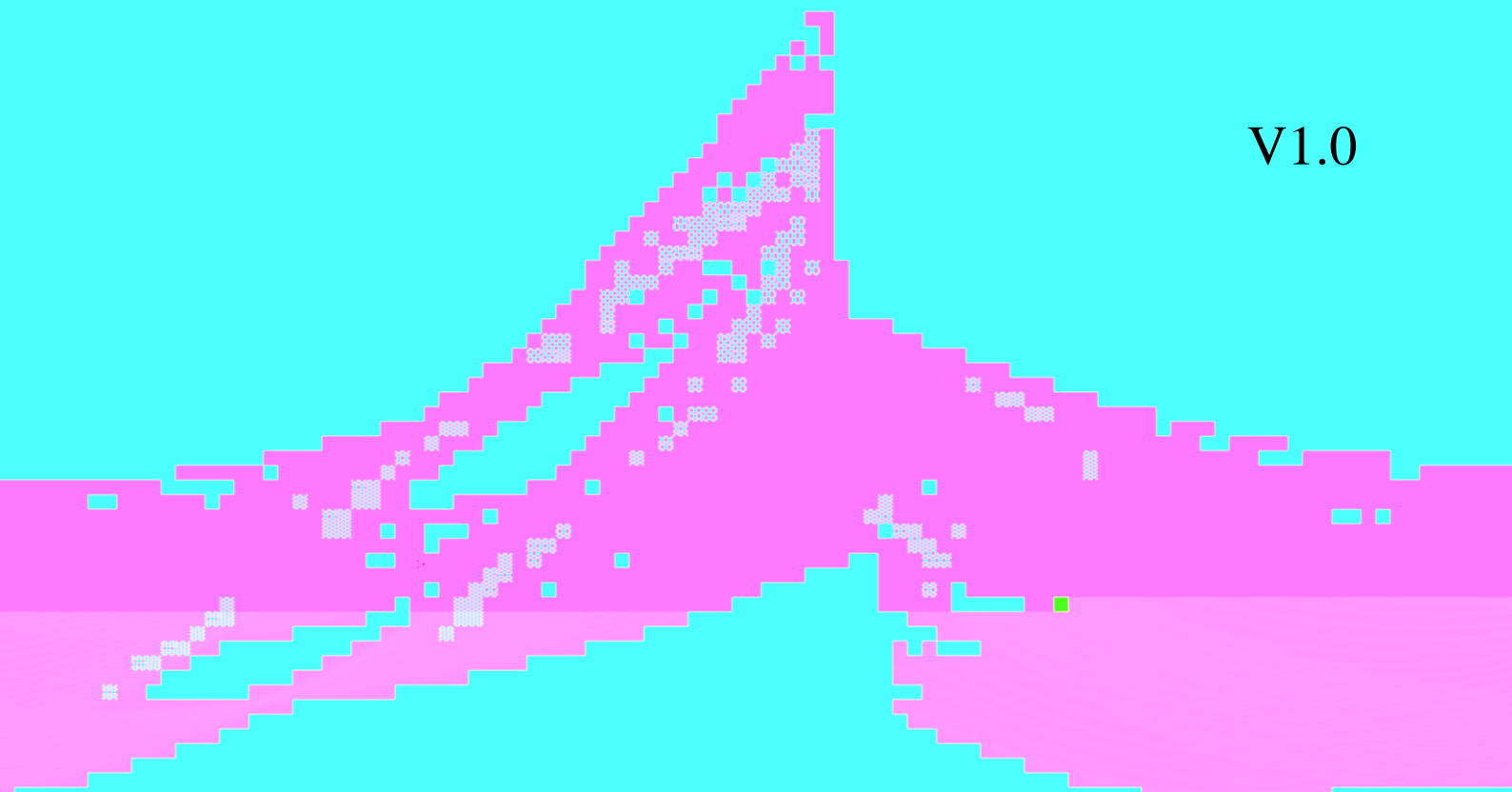

CSA401-P030T01

V1.0



1.

CSA401-P030T01

2.

3.

MRI

4.
 $T_A=25^{\circ}\text{C} \pm 5^{\circ}\text{C} \quad U_C=\pm 18\text{V} \quad R_M=18$

(DC)	I_{PN DC}	--	-400	--	400	A
(AC rms)	I_{PN AC}	--	--	282	--	A
	I_{POL}		-480	--	480	A

(DC)

U

6.

	T_A	--		-10	--	+70	°C
	T_S	--		-25	--	+85	°C
	--	DB9	8	LED		OD	D
		8		DB9	8		DB9
	m	--		0.5±0.02			kg

① DB9 8 D GND OD Open Drain
 8 GND 60V 2mA

7.

	U_w	50 s		--	5	--	kV
	CTI	IEC-60112		--	600	--	V

8.

8.1. (mm)

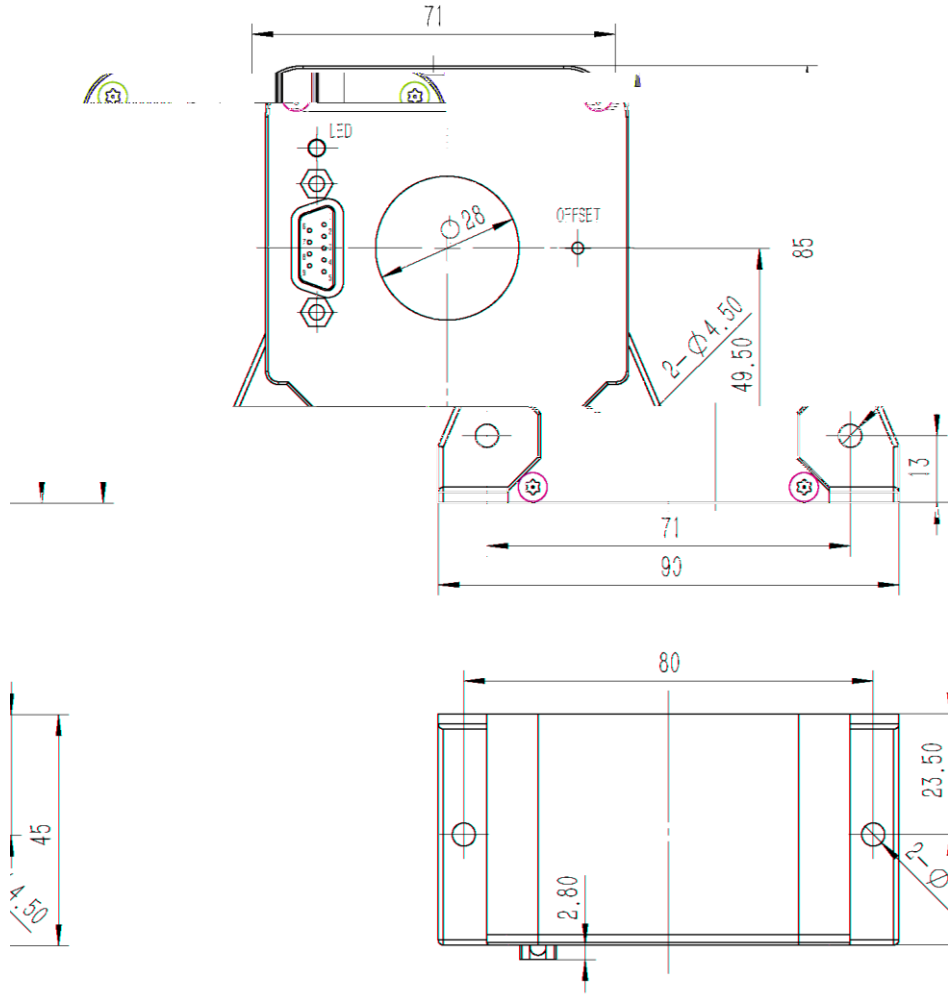

1

GB/T1804-2000 C

DB9

8.2. DB9

	1 3 4	2 7	5	6	8	9
	GND	NC	-Vc	Is		+Vc

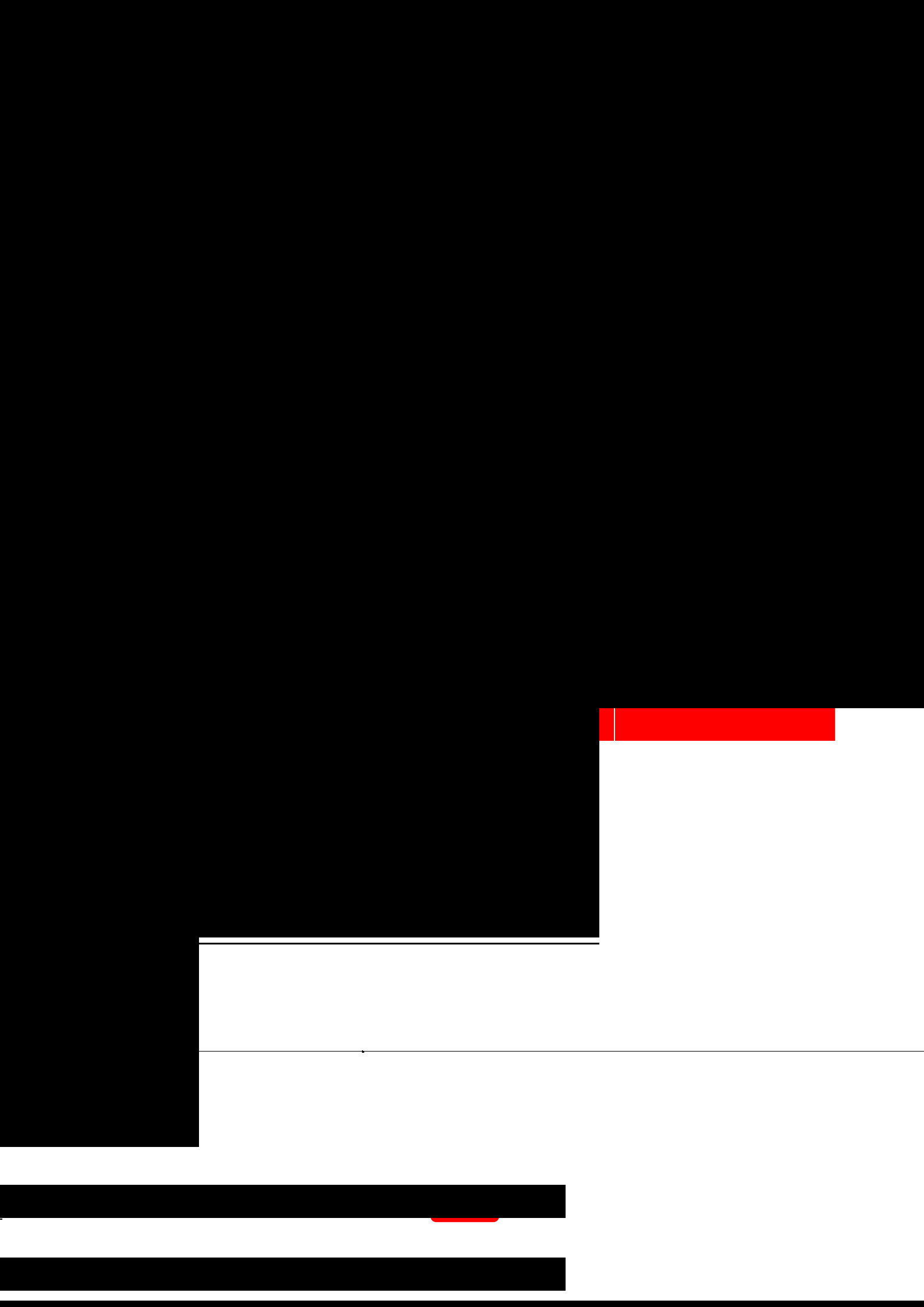

[Redacted]

[Redacted]

[Redacted]

[Redacted]

[Redacted]

[Redacted]

